

Operating Manual

Residual Current Device: OEI4A-HF TYPE-A

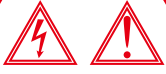

The RCD only be installed by an qualified electrical specialist!



HAZARD OF ELECTRIC SHOCK, EXPLOSION OR LIGHTNING.

Isolation, lockout, and tag power sources before and during installation or maintenance. Failure to follow these instructions could result in death or serious injury. The installer must ensure that all electrical connections are secure and the proper grounding has been made.

Technical Standards: IEC 61008-1, EN 61008-1

Technical Data

Art:	TYPE-A, Electromagnetic	Isolation voltage:	500V
Earth-leakage sensitivity(IΔn):	30mA, 100mA, 300mA	Rated breaking and making capacity (IΔm):	500A(In=25-40A) 630A(In=63A)1000A(In=80,100A)
Voltage rating (Ue):	2P 230V, 4P 400V,~ 50/60Hz	SCPD-backup:	63A(In=25-40A) 80A(In=63,80A) 100A(In=100A)
Rated Current:	25A,32A,40A,63A,80A,100A	Standard:	IEC 61008-1 EN 61008-1
Protection class:	IP20		
Mechanical durability:	3 000 Cycles		
Electrical durability:	2 000 Cycles		
Ambient operation temperature:	-25°C~+60°C		

Wiring diagram

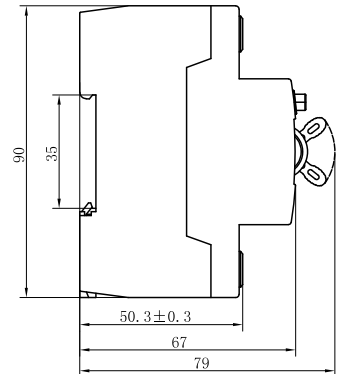
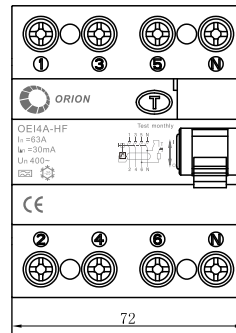
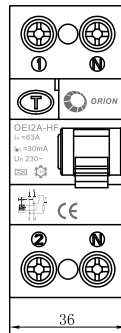
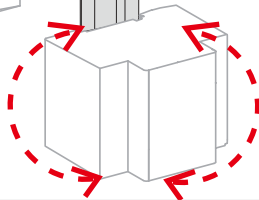
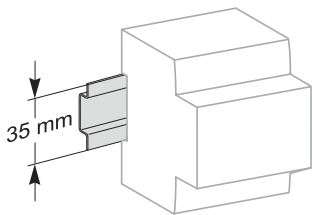
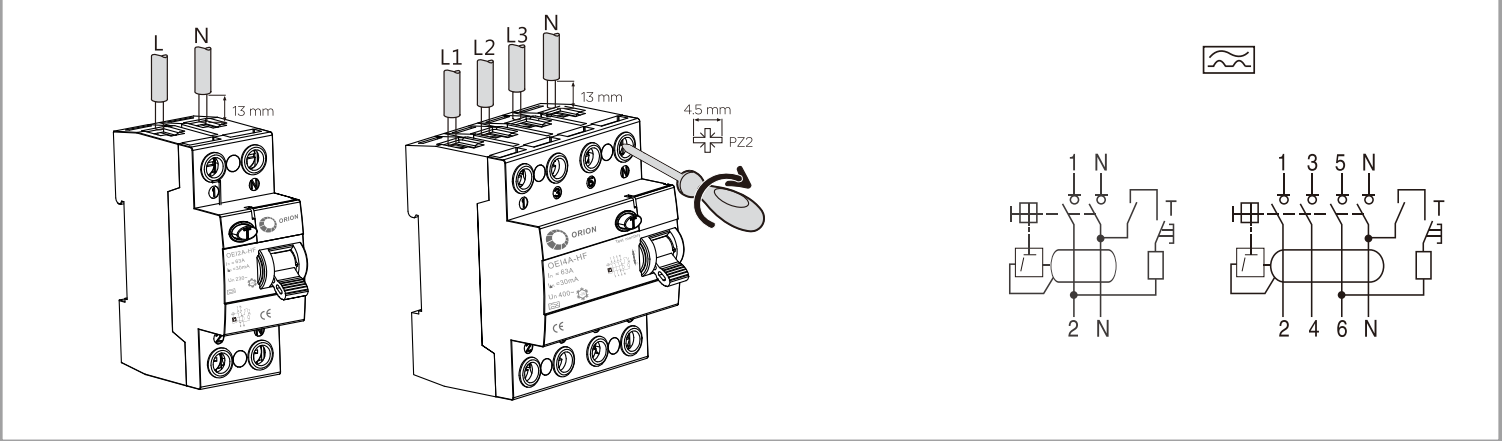

*All dimensions are in mm..

Test

- The effectiveness of the RCD in the protected installation should be checked periodically as specified in the applicable maintenance standard.
- To test the operation of the RCD after installation:
 - The RCD's switch must be in the ON position
 - To press the "test button" and confirm the power input
 - The RCD should trip immediately
 If the RCD no trip, there is either no voltage at the RCD or the device is defective.

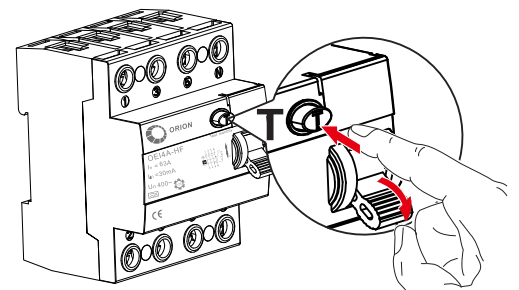

WARNINGS

Do not use the test button to turn off the RCD.
Failure to follow these instructions may result in equipment damage.